

WOODCREST AT CLARK

1500 Westfield Avenue, Clark, NJ 07066 (732) 860-5430



Woodcrest at Clark is Union County's Premier 55 + Adult Lifestyle Community. The community consists of four buildings with one and two bedroom floor plans, ranging from 900 to 1630 square feet. The spacious designs come complete with many upgrades including granite counters, breakfast bar, stainless steel appliances, large soaking tub, oversized master shower with double vanity and custom walk-in closets. Additional amenities include individually controlled central heat/air conditioning, storage/utility room with washer and a dryer, and a large private balcony. We offer a Clubhouse with a cozy fireplace, a Fitness Center, a Card Room and TV lounge.

www.WoodcrestAtClarkNJ.com (732) 860-5430



WE ARE AN EQUAL HOUSING OPPORTUNITY PROVIDER. WE DO NOT DISCRIMINATE ON THE BASIS OF RACE, COLOR, SEX, NATIONAL ORIGIN, RELIGION, HANDICAP OR FAMILIAL STATUS.

WF-Woodcrest090717



Woodcrest at Clark - 55+ Active Adult Community

| Bedrooms | Plan | Baths | Area | Pricing |
|----------|----------------|-------|--------------|---------|
| 1 | 1A2 | 1 | 900 sq. ft. | \$2170 |
| 1 | 1D2 - with Den | 1 | 1270 sq. ft. | \$2320 |
| 2 | 2A2 | 2 | 1340 sq. ft. | \$2500 |
| 2 | 2E2 - End Apt | 2 | 1460 sq. ft. | \$2750 |
| 2 | 2F1 - Bldg 4 | 2 | 1695 sq. ft. | \$3000 |
| 2 | 2D1 - Corner | 2 | 1630 sq. ft. | \$3000 |

*All prices are subject to change.

Apartment Amenities

- Breakfast Bar
- Hardwood Floors
- Private Patio or Balcony
- Washer & Dryer in Apartment
- Carpeted Bedrooms
- Large Soaking Tub
- Voluminous 9' High Ceilings
- Granite Kitchen Countertops
- Master Suite with Double Sink
- Walk-In Closet in Select Units

Community Amenities

- 24-Hour Emergency Maintenance
- Clubhouse
- TV Lounge
- Cable Ready
- Community Room
- Verizon FIOS Available
- Card Room
- Covered Parking

Appliances

- Dishwasher
- Refrigerator/Freezer
- Microwave
- Oven/Range

Visit our website - www.WoodcrestAtClarkNJ.com

Rental Office Hours

| Monday | Tuesday | Wednesday | Thursday | Friday | Saturday | Sunday |
|-----------|-----------|-----------|-----------|-----------|----------|--------|
| 8:30-4:30 | 8:30-4:30 | 8:30-4:30 | 8:30-4:30 | 8:30-4:30 | Closed | Closed |

When you decide to join us, please provide us the following at time of application:

- Two Personal Checks or Money Orders. We do not accept cash:
 1. Non-refundable Application processing Fee payable to GARDEN HOMES. \$75 per applicant.
 2. \$500 check payable to CLARK DEVELOPERS LLC. To be applied to your Security Deposit upon approval; or refunded if your application is declined.
- Two Current Pay Stubs
- Valid Photo ID
- Social Security Card

We are an equal opportunity provider. We do not discriminate on the basis of race, color, sex, national origin, religion, handicap or familial status.

1500 Westfield Ave, Clark, NJ 07066
P: (732) 860-5430 F: (732) 333-6351

7/31/2021



www.WoodcrestAtClarkNJ.com

WoodcrestAtClark.Rental@GardenCommunities.com

Woodcrest at Clark

One Bedroom Floor Plan
with 1 Bath, 900 sq. ft.

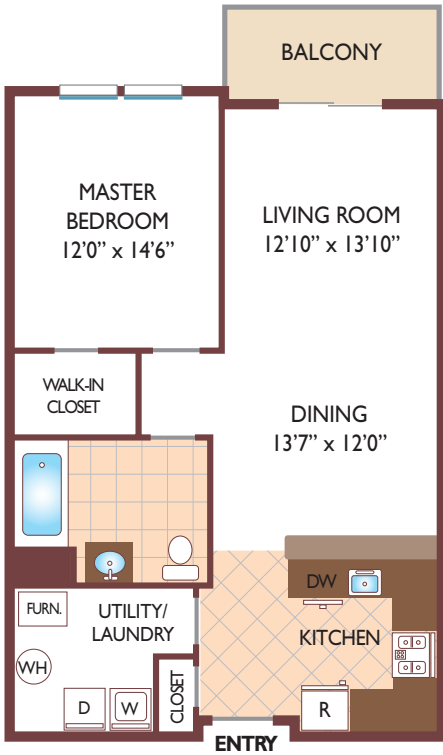

One Bedroom w/ Den Floor Plan
with 1 Bath, 1270 sq. ft.



Two Bedroom Floor Plan
with 2 Baths, 1340 sq. ft.



All dimensions, positions, locations and details are approximate.
All rent prices and community information subject to change.

Two Bedroom Floor Plan

with 2 Baths, 1460 sq. ft.

• End View Apartment •



Two Bedroom Floor Plan

with 2 Baths, 1630 sq. ft.

• Corner Apartment •



All dimensions, positions, locations and details are approximate.

All rent prices and community information subject to change.

